

Contractual work

- It is compulsory to wear personal protective equipment for certain work. You should bring the required personal protective equipment yourself and ensure that it is used properly. In certain cases, the equipment will be provided by Dr. Pflieger.
- In the case of work involving open flames, building and electromechanical work, permission should be requested in advance from the technical service. Contractual companies may only carry out their work upon receiving written permission.
- To drive/handle a forklift truck you require written permission from the technical service.
- The contractor is responsible that the valid regulations described in the German Occupational Safety and Health Act, including its regulations and technical rules, are complied with.

Access/Arrival

- On-site parking is only permitted within the marked areas.
- Speed limit is max. 10km/h.
- **Registration:** When you enter the factory premises, please register at reception where you will receive a visitor identification card. During your stay, this ID card should be carried visibly.
- If you receive an access chip (Legic), its use is only for your personal access. You are not allowed to grant anybody else access.
- **Checking-out:** At the end of your stay, make sure that you sign off at reception and that you give your ID card and Legic back.

Behaviour on the factory premises

Please follow staff instructions.

- Observe and comply to in particular hygiene and dress regulations in the manufacturing and packaging sector.
- It is prohibited to access and take Dr. Pflieger owned material.
- Use the designated pathways which are marked yellow in the building and red in the outdoor area (exceptions only by permission, e.g. work from external companies). The area in front of the loading ramps in the goods receiving area may only be entered by the haulage driver or the loading/unloading personnel. Other persons must use the marked pathways.

Behaviour in case of emergency/fire

- Remain calm.
- Report the fire,
Company internal emergency call:
Emergency services:
- Seek shelter.
- Attempt to extinguish fire.
- Use the emergency escape route and seek the evacuation assembly point.

-222
112



Note also the information on the notice board located close to the canteen.

In case of problems or emergencies, please alert your responsible contact person or the technical service.

Contact technical service

Head of Infrastructure and Maintenance: -239

Technical Service: -188
-286



WELCOME TO DR. PFLEGER ARZNEIMITTEL GMBH

Please read the following brochure carefully. It contains important information regarding conduct at our factory premises. Please follow the described rules and advice. In case of infringement we reserve the right to take legal action.

Thank you.

Kind regards,
General Management
Dr. Pflieger Arzneimittel GmbH

Dr. Pflieger Arzneimittel GmbH

**Production/Goods Receiving
Department/Laboratory**
Dr.-Robert-Pflieger-Str. 12
96052 Bamberg (Germany)

Administration
Emil-Kemmer-Straße 33
96103 Hallstadt (Germany)

Telephone: +49 (0)951 60 43-0
Fax: +49 (0)951 60 43-29
E-Mail: info@dr-pflieger.de

GMP-Requirements

Dr. Pflieger is a drug manufacturer and has to obey regulatory requirements and legal obligations (AMWHV, AMG incl. GMP).

To ensure the compliance, we would like to familiarize you with the required special safety measures.

General Instructions



Photography and filming are prohibited.



Open flames, fire and ignition sources are prohibited.



Smoking is only permitted in the designated areas.



Eating and drinking are only allowed in the assigned rooms.



Off limits to unauthorised personnel.



Wear eye protection.



Wear safety footwear.



Wear ear protection.



Wear a head cover.



Use protective clothing.

Map of the factory premises

in Dr.-Robert-Pfleger-Straße 12

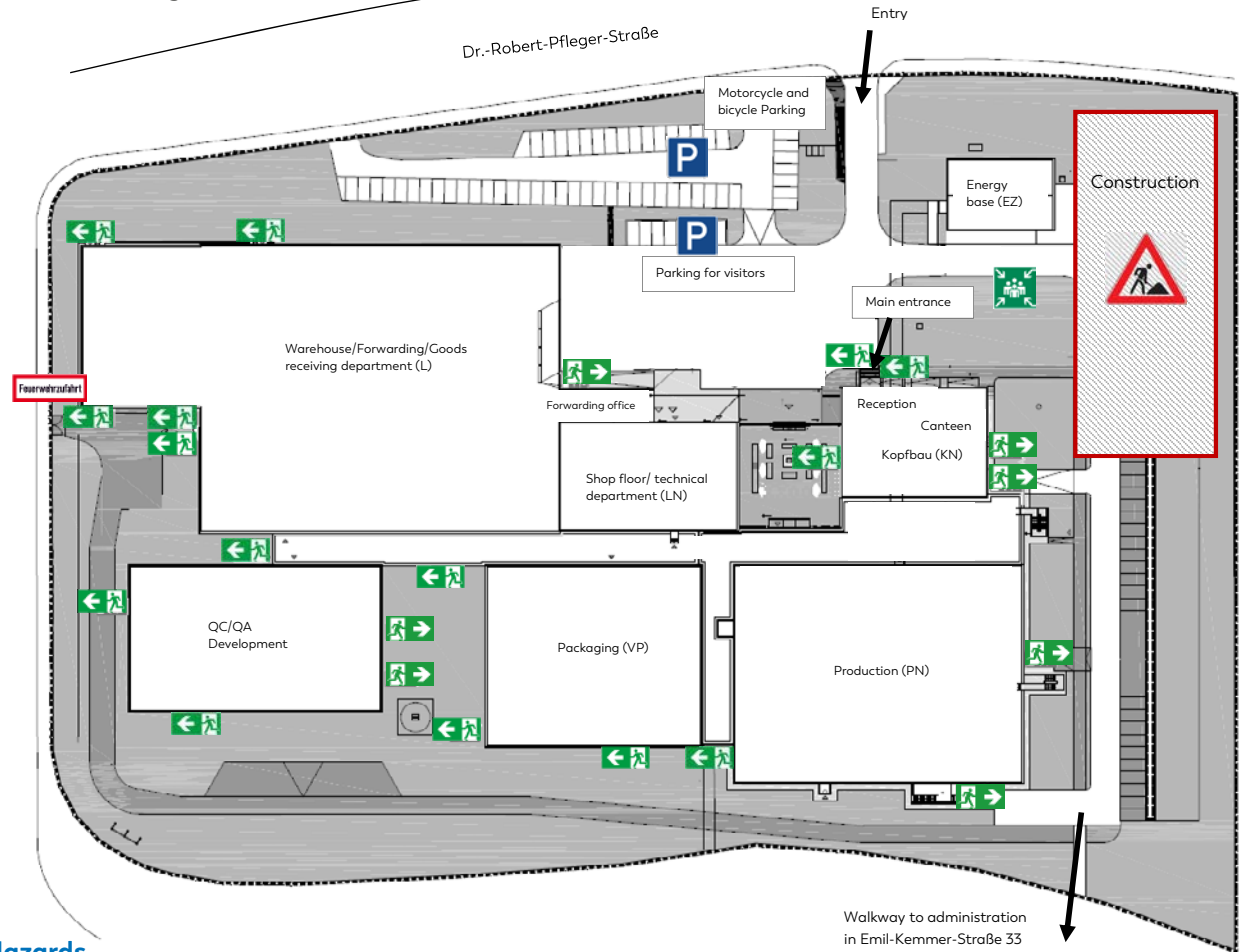

Hazards



Flammable (F): Stay away from open flames, sparks and heat sources.



Health hazard/Hazardous to the ozone layer: Avoid contact with human body.



Serious health hazard: Avoid contact with eyes and skin; Do not inhale vapours (for instance solvents).



Corrosive (C): Use protective measures to avoid contact with eyes, skin and clothes. Do not inhale vapours (for instance hydrochloric acid, sulphuric acid, caustic soda).



Acute toxicity (T): Avoid any contact with the human body. High health hazard including death (for instance methanol).



Explosive (EX): Highly flammable solvents air mixtures (for instance methanol-air mixtures).



Warning: Forklift trucks, industrial vehicles and automated guided vehicles.